

ON POINT - Friday, January 17, 2020 7:46 AM F:\124 SEACLIFF MCCALLUM ROAD\02 MASTER PLANNING\03 CAD & DESIGN\OUTFILES\20200115 CAD\124-02 PLAN.DWG

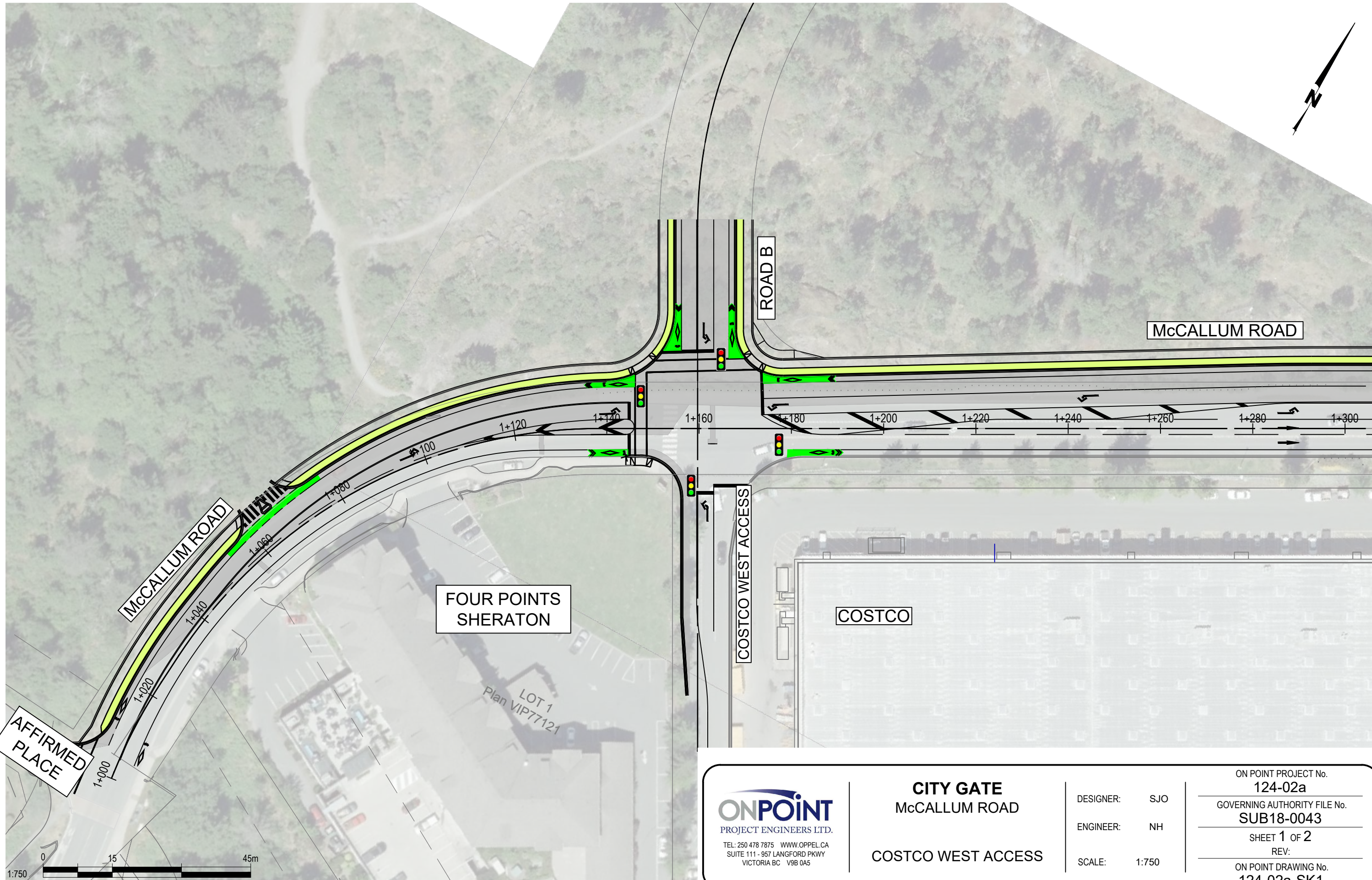

SEE DRAWING 124-02a-SK2 FOR CONTINUATION

AFFIRMED PLACE

MCCALLUM ROAD

ROAD B

MCCALLUM ROAD

FOUR POINTS SHERATON

COSTCO WEST ACCESS

COSTCO

LOT 1
Plan VIP77121

ONPOINT
PROJECT ENGINEERS LTD.
TEL: 250 478 7875 WWW.OPPEL.CA
SUITE 111 - 957 LANGFORD PKWY
VICTORIA BC V9B 0A5

CITY GATE
MCCALLUM ROAD

COSTCO WEST ACCESS

DESIGNER: SJO
ENGINEER: NH
SCALE: 1:750

ON POINT PROJECT No.
124-02a

GOVERNING AUTHORITY FILE No.
SUB18-0043

SHEET **1** OF **2**
REV:

ON POINT DRAWING No.
124-02a-SK1

